

# SITE PLAN 1:750

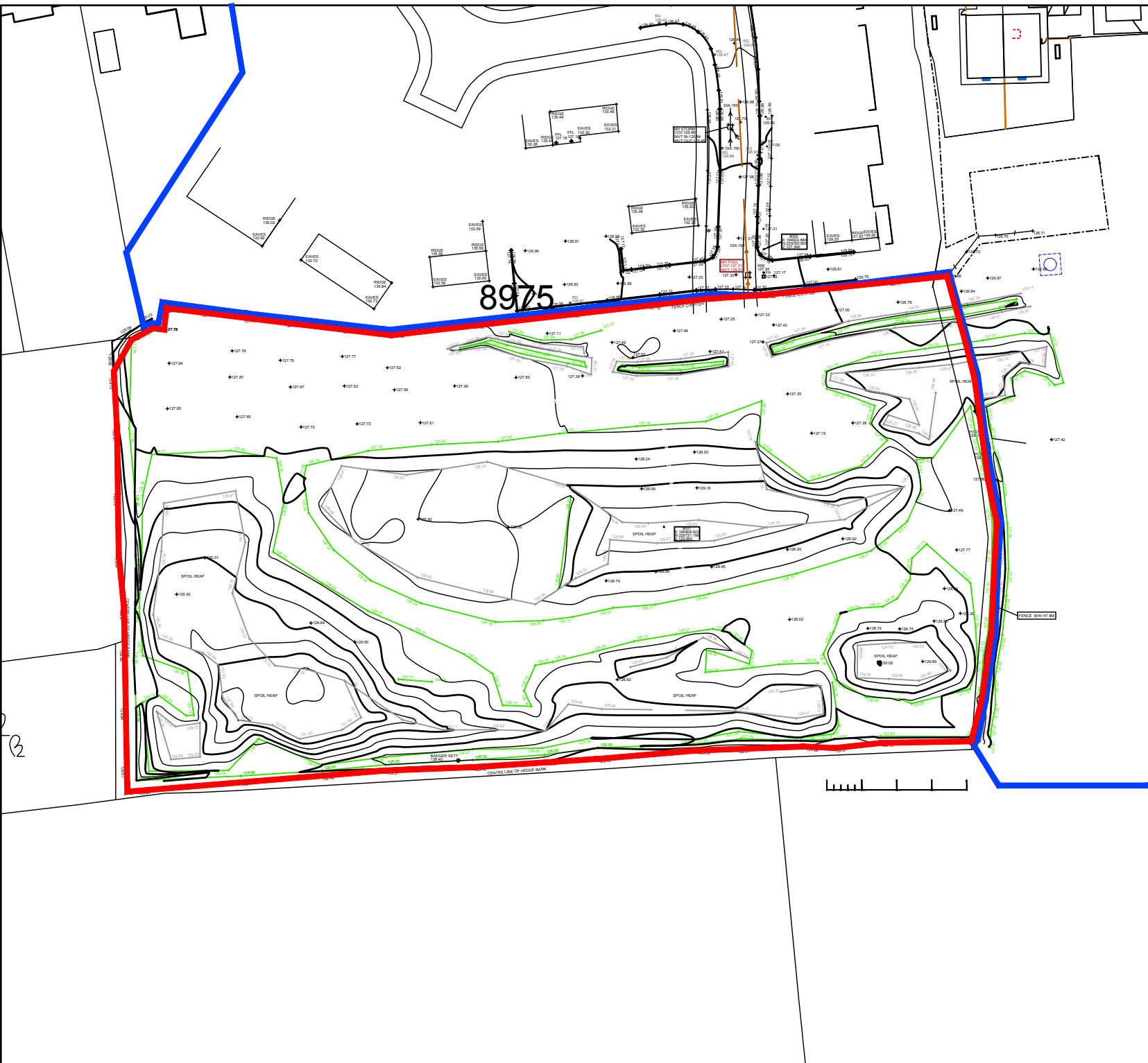

Rev	Amendments	Date	Ckd By
A	Land ownership amended	07/05/19	pjl

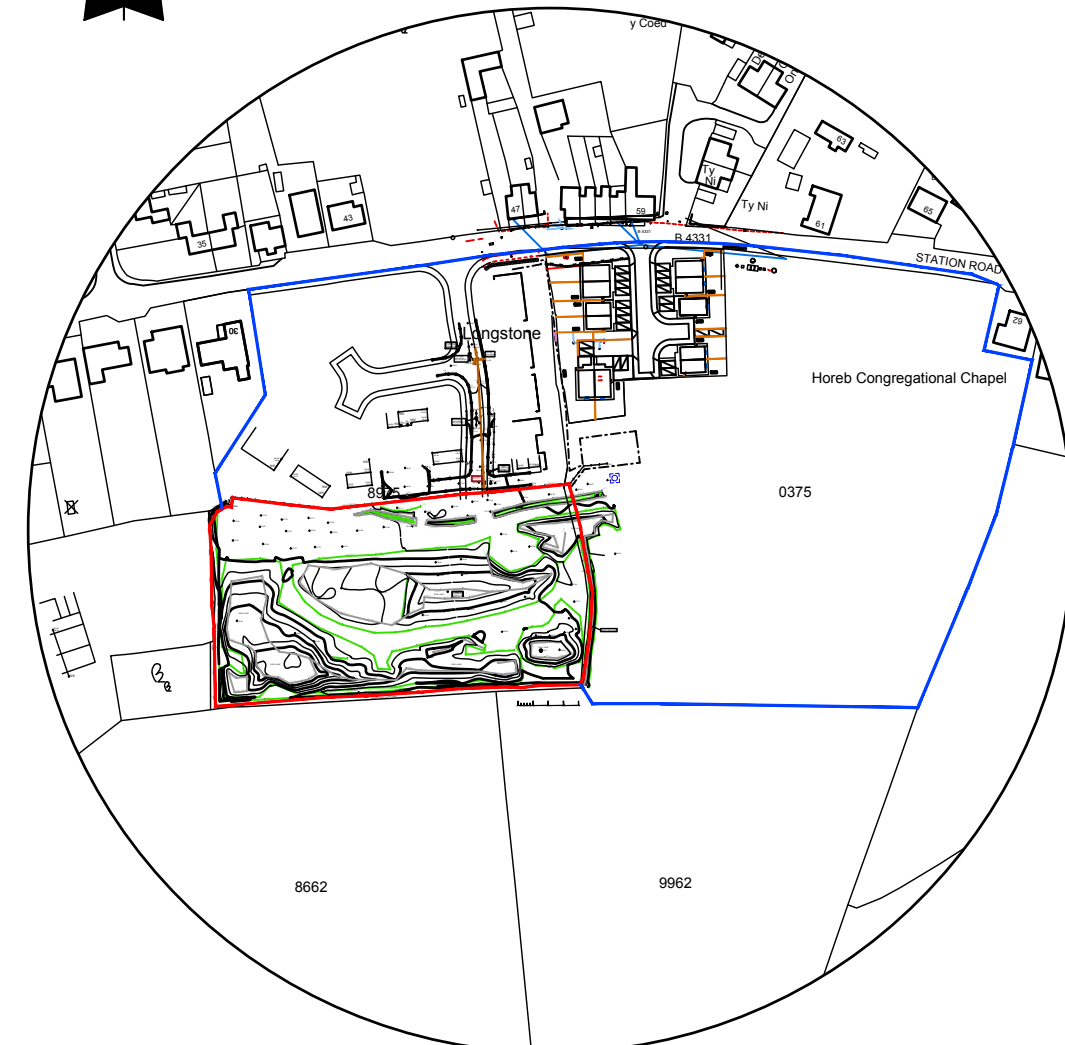
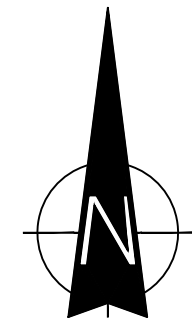

# LOCATION PLAN 1:2500



Map reference	SM 9429	Reproduced from the Ordnance Survey mapping with the permission of the controller of Her Majesty's Stationery Office © Crown copyright. Unauthorised reproduction infringes Crown copyright and may lead to prosecution or civil Proceedings. Licence No. AR100006113
---------------	---------	---

Only use figured dimensions. Any discrepancies must be reported to LEWIS PARTNERSHIP LIMITED. The copyright of this drawing remains the property of LEWIS PARTNERSHIP LIMITED. Lewis Partnership Limited, registered in Wales, reg no. 3913005



13 Park Crescent LLANELLI Carmarthenshire SA15 3AE  
01554 777998  
enquiries@lewispartnership.co.uk  
WWW.lewispartnership.co.uk



**Project**  
PROPOSED RESIDENTIAL DEVELOPMENT  
Location : LAND OFF STATION ROAD, LETTERSTON  
Client : JONATHAN COLE, ATEB

**Title**  
EXISTING SITE & LOCATION PLANS

Project Number	1840	Drawing Number	01	Rev.	A	Scale/s	AS SHOWN	Status	FEASIBILITY	A3
----------------	------	----------------	----	------	---	---------	----------	--------	-------------	----

Date Drawn	By
02/18	gp
Date Checked	By
07/02/18	pjl